

SMT Toroidal Power Inductors GSSH01 / GSSH02 / GSSH03

Features (特長)

- Closed magnetic circuit for lowest EMI
(閉合磁性電路防干擾對策)
- High performance low loss powder iron core is excellent for high frequency applications
(高性能低損失之鐵芯運用於高頻佳)
- Compatible with vapor phase and infrared reflow soldering
(應用於氣相及紅外式回流焊錫)

Applications (用途)

- Notebook (筆記型電腦)
- DC/DC Converter (直流轉換器)
- Output Ripple Current Filter
(訊號濾波應用)



Product Identification (產品識別)

GSSH01 - - (Ex. GSSH01-60E-151M)

1 2 3 4

1. SMD Toroidal Power Inductors (環型功率電感) (GSSH01, GSSH02, GSSH03)
2. Core Material (鐵芯材質)
3. Inductance (電感值)
4. Tolerance (誤差值) (參照表 M 20%, N 30%)

SMD Toroidal Power Inductors GSSH01 / GSSH02 / GSSH03

Configurations & Dimensions (結構圖及規格尺寸)

GSSH01

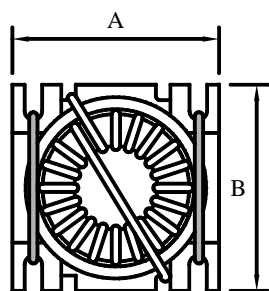

Bottom View

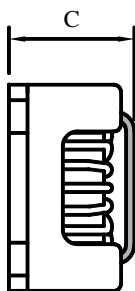

Side View

Land Pattern

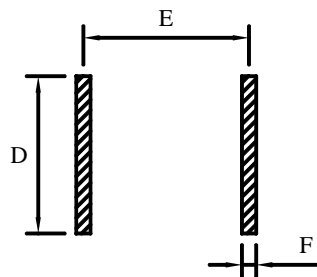

GSSH02

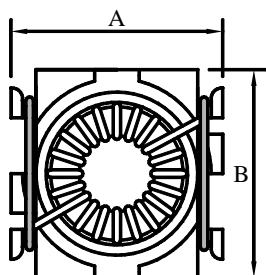

Bottom View

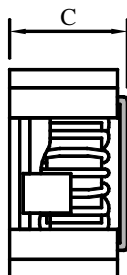

Side View

Land Pattern

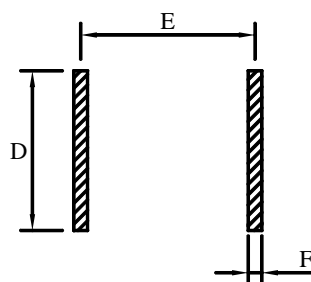

GSSH03

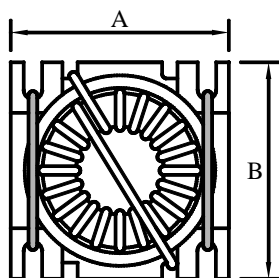

Bottom View

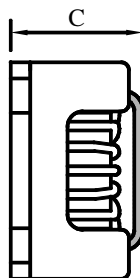

Side View

Land Pattern

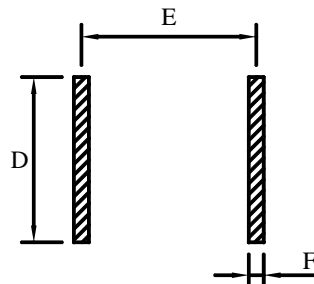

Unit In mm

Type (型式)	A ±0.5	B ±0.5	C (max)	D	E	F
GSSH01	15.4	14.5	8.80	13.0	12.5	2.5
GSSH02	15.7	15.3	9.40	12.8	13.0	2.5
GSSH03	14.2	14.1	8.80	12.5	11.3	2.5

♣ Design as Customer's Requested Specifications. (可依客戶特殊需求設計)